

## АРМАТУРА И АКСЕССУАРЫ

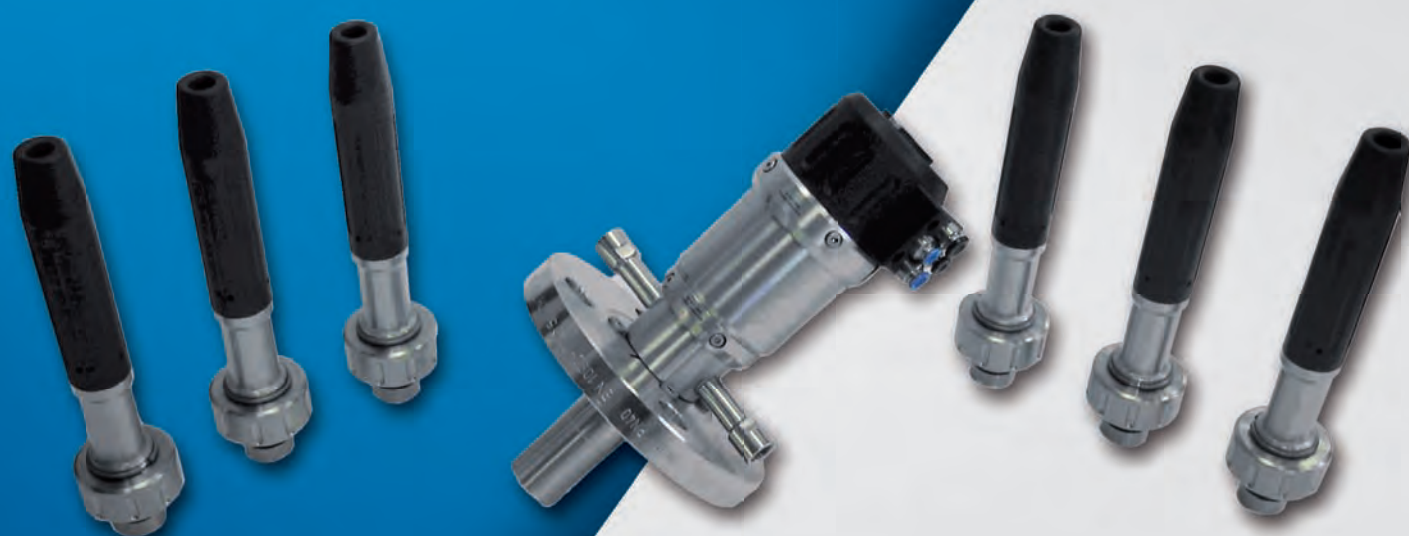

По вопросам продаж и поддержки обращайтесь:

Архангельск (8182)63-90-72  
Астана +7(7172)727-132  
Белгород (4722)40-23-64  
Брянск (4832)59-03-52  
Владивосток (423)249-28-31  
Волгоград (844)278-03-48  
Вологда (8172)26-41-59  
Воронеж (473)204-51-73  
Екатеринбург (343)384-55-89  
Иваново (4932)77-34-06  
Ижевск (3412)26-03-58  
Казань (843)206-01-48

Калининград (4012)72-03-81  
Калуга (4842)92-23-67  
Кемерово (3842)65-04-62  
Киров (8332)68-02-04  
Краснодар (861)203-40-90  
Красноярск (391)204-63-61  
Курск (4712)77-13-04  
Липецк (4742)52-20-81  
Магнитогорск (3519)55-03-13  
Москва (495)268-04-70  
Мурманск (8152)59-64-93  
Набережные Челны (8552)20-53-41

Нижний Новгород (831)429-08-12  
Новокузнецк (3843)20-46-81  
Новосибирск (383)227-86-73  
Орел (4862)44-53-42  
Оренбург (3532)37-68-04  
Пенза (8412)22-31-16  
Пермь (342)205-81-47  
Ростов-на-Дону (863)308-18-15  
Рязань (4912)46-61-64  
Самара (846)206-03-16  
Санкт-Петербург (812)309-46-40  
Саратов (845)249-38-78

Смоленск (4812)29-41-54  
Сочи (862)225-72-31  
Ставрополь (8652)20-65-13  
Тверь (4822)63-31-35  
Томск (3822)98-41-53  
Тула (4872)74-02-29  
Тюмень (3452)66-21-18  
Ульяновск (8422)24-23-59  
Уфа (347)229-48-12  
Челябинск (351)202-03-61  
Череповец (8202)49-02-64  
Ярославль (4852)69-52-93

# Static sensor holders

## CHEMfit 310

Static sensor holder for permanent installation of Ø12 mm/120 mm-sensors on **welding sockets DN25** in tanks or pipes.

- Application:**
- ▲ For all kind of Ø12/120 mm sensors with thread PG13.5 (e.g. pH- and REDOX, conductivity and temperature and turbidity sensors)
  - ▲ Food production
  - ▲ Chemical and pharmaceutical production
  - ▲ Water treatment

- Benefits:**
- ▲ Designed according to hygienic criteria
  - ▲ Surface finish  $Ra < 0.8$  or  $Ra < 0.4$
  - ▲ Stainless steel AISI 316L / 1.4404
  - ▲ EPDM sealing with FDA and USP VI approval
  - ▲ Optional sensor protection cage
  - ▲ Up to 10 bar and 140°C
  - ▲ Protection cap for cable connection

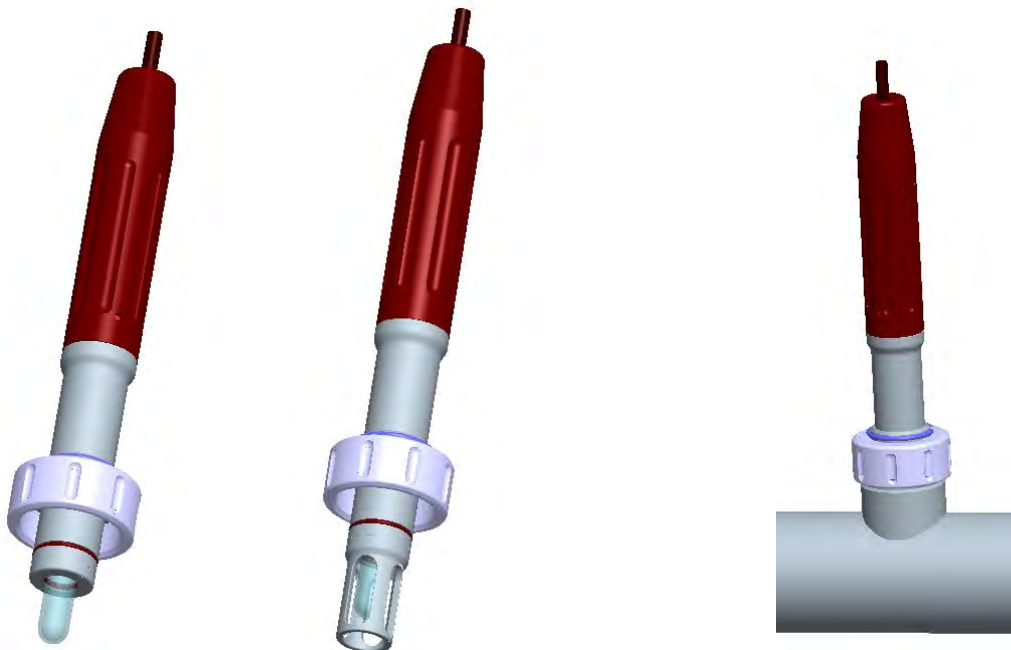

# Static sensor holders

## CHEMfit 311

Static sensor holder with **TriClamp connection** for permanent installation of Ø12 mm/120 mm-sensors in tanks or pipes.

- Application:**
- ▲ For all kind of Ø12 / 120 mm sensors with thread PG 13.5 (e.g. pH- and REDOX, conductivity and temperature and turbidity sensors)
  - ▲ Food production
  - ▲ Chemical and pharmaceutical production

- Benefits:**
- ▲ Designed according to hygienic criteria
  - ▲ Surface finish  $Ra < 0.8$  or  $Ra < 0.4$
  - ▲ Stainless steel AISI 316L / 1.4404
  - ▲ EPDM sealing with FDA and USP VI approval
  - ▲ Optional sensor protection cage
  - ▲ Up to 10 bar and 140°C
  - ▲ Protection cap for cable connection

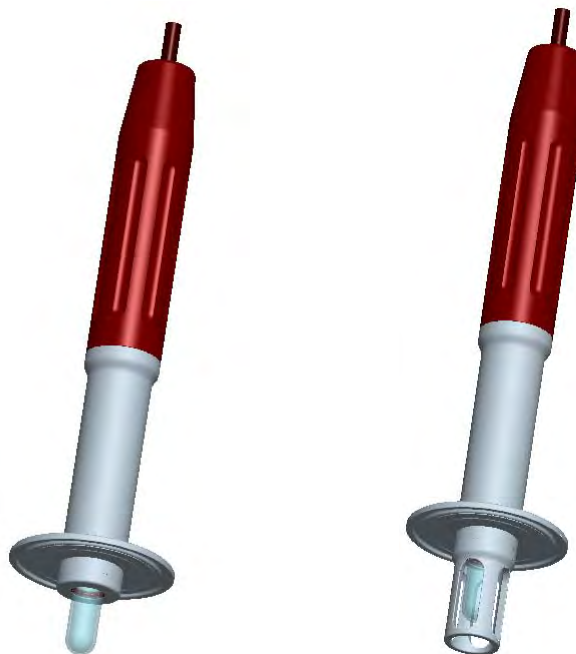

# Static sensor holders

## CHEMfit 312

Static sensor holder with **hygienic process connections** for permanent installation of Ø12 mm/120 mm sensors in tanks or pipes.

- Application:**
- ▲ For all kind of Ø12/120 mm sensors with thread PG13.5 (e.g. pH- and REDOX, conductivity and temperature and turbidity sensors)
  - ▲ Food production
  - ▲ Pharmaceutical production

- Benefits:**
- ▲ Designed according to hygienic criteria
  - ▲ Surface finish  $Ra < 0.8$  or  $Ra < 0.4$
  - ▲ Stainless steel AISI 316L / 1.4404
  - ▲ EPDM sealing with FDA and USP VI approval
  - ▲ Optional sensor protection cage
  - ▲ Up to 10 bar and 140°C
  - ▲ Protection cap for cable connection

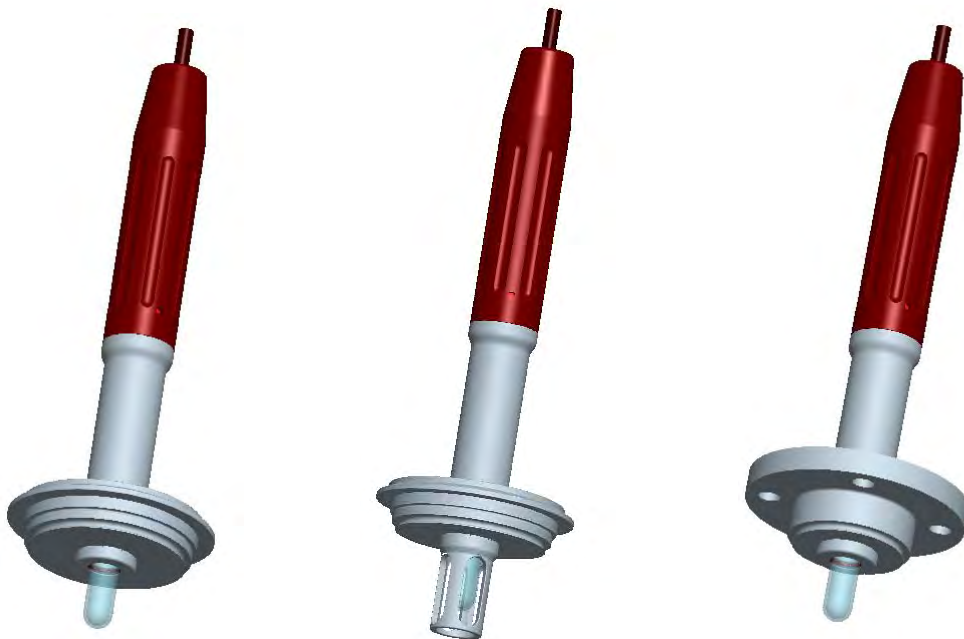

# Static sensor holders

## CHEMfit 315

Static sensor holder with **15°-angled process connections** for permanent installation of Ø12 mm/120 mm-sensors in tanks or pipes mainly in **hygienic applications**.

- Application:**
- ▲ For all kind of Ø12/120 mm sensors with thread PG13.5 (e.g. pH- and REDOX, conductivity and temperature and turbidity sensors)
  - ▲ Food production
  - ▲ Chemical and pharmaceutical production
  - ▲ Especially for the use in vertical pipe connections

- Benefits:**
- ▲ Designed according to hygienic criteria
  - ▲ Surface finish  $Ra < 0.8$  or  $Ra < 0.4$
  - ▲ Stainless steel AISI 316L / 1.4404
  - ▲ EPDM sealing with FDA and USP VI approval
  - ▲ Up to 10 bar and 140°C
  - ▲ Protection cap for cable connection

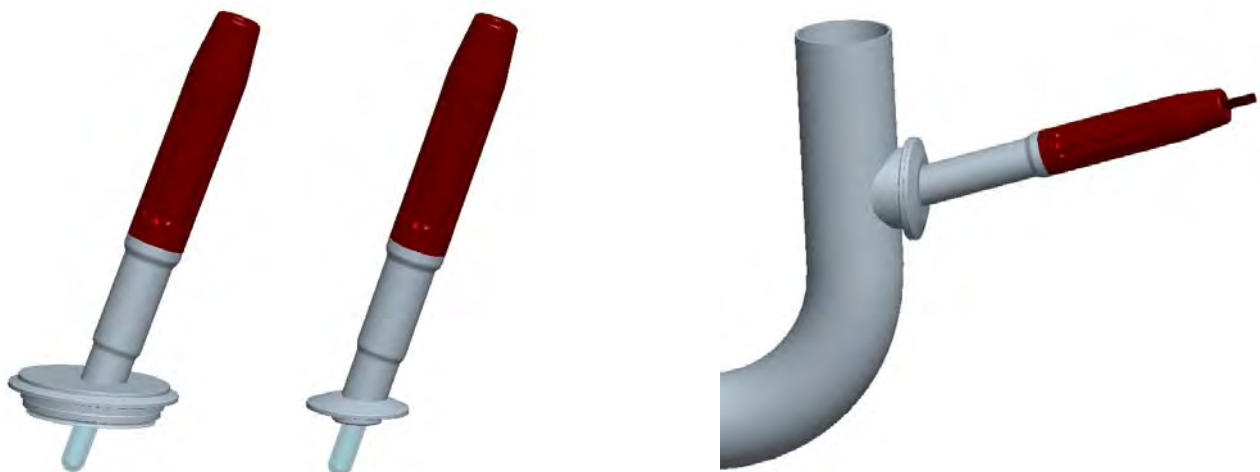

# Dip holders - *static*

## CHEMdip 910 – DN50/ANSI 2" stainless steel

Immersion holder made of stainless steel with **flange** connection and integrated orbital sensor cleaning system for **nominal diameter DN50 / 2"**.

- Application:**
- ▲ For all kind of Ø12/120 mm sensors with thread PG13.5 (e.g. pH- and REDOX, conductivity and temperature and turbidity sensors)
  - ▲ Chemical production
  - ▲ Water and wastewater treatment
  - ▲ Permanent installation in tanks, vessels or open channels

- Benefits:**
- ▲ Robust design
  - ▲ Integrated orbital sensor cleaning system
  - ▲ Extension of sensor-lifetime and reducing of maintenance costs
  - ▲ Easy installation and removal of the sensor holder
  - ▲ Stainless steel AISI 316L / 1.4404 or hastelloy
  - ▲ Immersion length 500 – 2500 mm
  - ▲ Minimum size DN50/2"
  - ▲ Up to 10 bar and 140°C
  - ▲ No external cleaning device necessary



# Dip holders - *static*

## CHEMdip 920 – DN50/ANSI 2" plastics

Immersion holder made of plastics with **flange connection** or suspension and integrated orbital sensor cleaning system for nominal **diameter DN50/2"**.

- Application:**
- ▲ For all kind of Ø12/120 mm sensors with thread PG13.5 (e.g. pH- and REDOX, conductivity and temperature and turbidity sensors)
  - ▲ Chemical production
  - ▲ Water and wastewater treatment
  - ▲ Permanent installation in tanks, vessels or open channels

- Benefits:**
- ▲ Robust design
  - ▲ Integrated orbital sensor cleaning system
  - ▲ Extension of sensor-lifetime and reducing of maintenance costs
  - ▲ Easy installation and removal of the sensor holder
  - ▲ PP or PVDF
  - ▲ Immersion length 500 – 2500 mm
  - ▲ Minimum size DN50/2"
  - ▲ Up to 6 bar and 80°C
  - ▲ No external cleaning device necessary

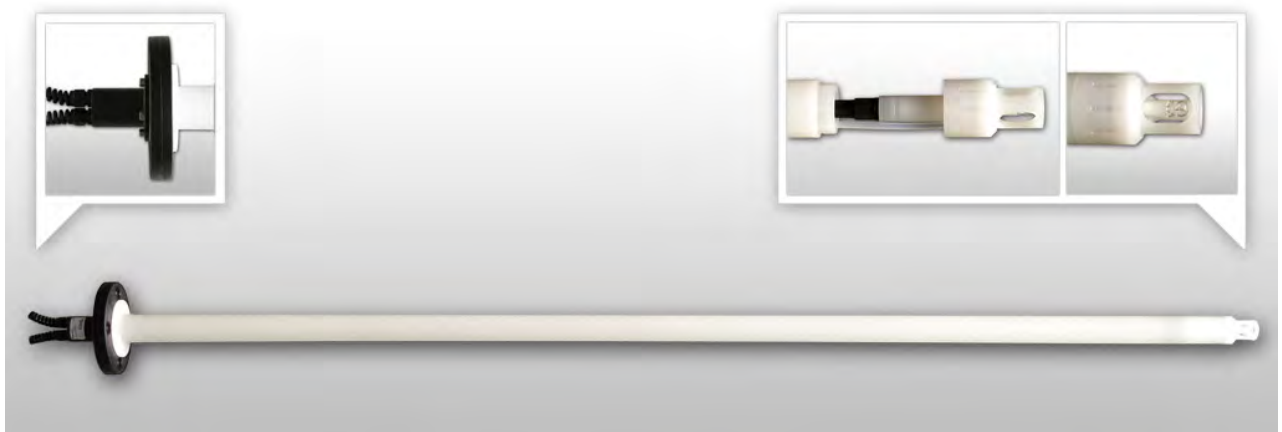



# Dip holders - *static*

## CHEMdip 915 – DN80/ANSI 3" stainless steel

Immersion holder made of stainless steel with **flange** connection and integrated orbital sensor cleaning system for **nominal diameter DN80/3"**.

- Application:**
- ▲ For all kind of Ø12/120 mm sensors with thread PG 13.5 (e.g. pH- and REDOX, conductivity and temperature and turbidity sensors)
  - ▲ Chemical production
  - ▲ Water and wastewater treatment
  - ▲ Permanent installation in tanks, vessels or open channels

- Benefits:**
- ▲ Robust design
  - ▲ Integrated orbital sensor cleaning system
  - ▲ Extension of sensor-lifetime and reducing of maintenance costs
  - ▲ Easy installation and removal of the sensor holder
  - ▲ Suitable for liquid-filled sensors
  - ▲ Stainless steel AISI 316L / 1.4404
  - ▲ Immersion length 500 – 2500 mm
  - ▲ Minimum size DN80/3"
  - ▲ Up to 8 bar and 140°C
  - ▲ No external cleaning devices necessary





# Dip holders - *static*

## CHEMdip 925 – DN80/ANSI 3" plastics

Immersion holder made of plastics with **flange connection** or suspension and integrated orbital sensor cleaning system for **nominal diameter DN80 / 3"**.

- Application:**
- ▲ For all kind of Ø12/120 mm sensors with thread PG13.5 (e.g. pH- and REDOX, conductivity and temperature and turbidity sensors)
  - ▲ Chemical production
  - ▲ Water and wastewater treatment
  - ▲ Permanent installation in tanks, vessels or open channels

- Benefits:**
- ▲ Robust design
  - ▲ Integrated orbital sensor cleaning system
  - ▲ Extension of sensor-lifetime and reducing of maintenance costs
  - ▲ Easy installation and removal of the sensor holder
  - ▲ Suitable for liquid-filled sensors
  - ▲ PP or PVDF
  - ▲ Immersion length 500 – 2500 mm
  - ▲ Minimum size DN80/3"
  - ▲ Up to 6 bar and 140°C
  - ▲ No external cleaning devices necessary



# Dip holders - *retractable*

## CHEMdip 918 – DN100/ANSI 4" stainless steel

Immersion holder made of stainless steel combined with a **retractable unit and cleaning chamber**, equipped with **flange connection for nominal diameter DN100 / 4"**.

- Application:**
- ▲ For all kind of Ø12/225 mm or Ø12/280 mm sensors with thread PG 13.5 (e.g. pH- and REDOX, conductivity and temperature and turbidity sensors)
  - ▲ Chemical production
  - ▲ Water and wastewater treatment
  - ▲ Permanent installation in tanks, vessels or open channels

- Benefits:**
- ▲ Integrated retractable unit for automated sensor cleaning
  - ▲ Extension of sensor-lifetime and reducing of maintenance costs
  - ▲ Easy installation and removal of the sensor holder
  - ▲ Suitable for liquid-filled sensors
  - ▲ Stainless steel AISI 316Ti / 316L (1.4571/1.4404)
  - ▲ Immersion length 1000 – 2500 mm
  - ▲ Minimum size DN100/4"
  - ▲ Up to 8 bar and 95°C
  - ▲ No external cleaning system necessary
  - ▲ Can be fully automated with pneumatic or electro-pneumatic control units (e.g. CHEMtrol 450 or CHEMtrol 460)

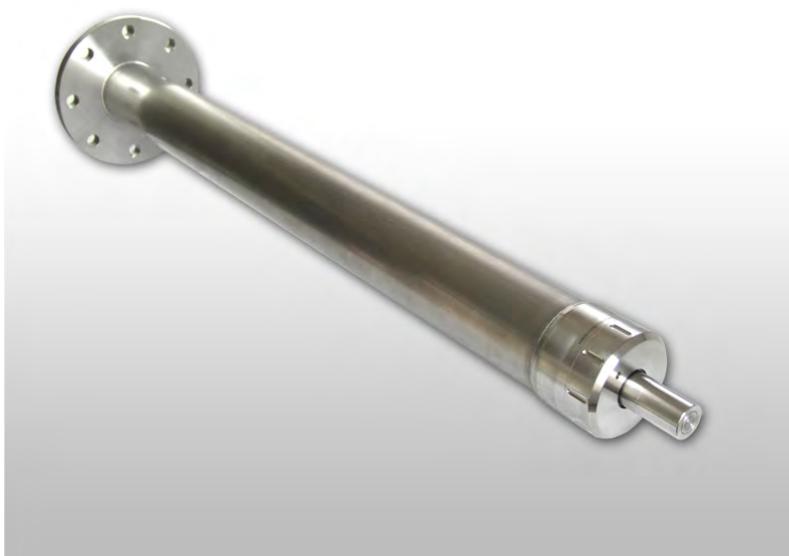

# Dip holders - *automatic*

## CHEMdip 928 – DN100/ANSI 4" PVDF

Immersion holder made of PVDF combined with a **retractable unit and cleaning chamber**, equipped **with flange** connection or suspension for **nominal diameter DN100 / 4"**.

- Application:**
- ▲ For all kind of Ø12/225 mm (gel-filled) or Ø12/280 mm (liquid-filled) sensors with thread PG 13.5 (e.g. pH- and REDOX, conductivity and temperature and turbidity sensors)
  - ▲ Chemical production
  - ▲ Water and wastewater treatment
  - ▲ Permanent installation in tanks, vessels or open channels with automatic sensor cleaning

- Benefits:**
- ▲ Integrated retractable unit for automatic sensor cleaning
  - ▲ Extension of sensor-lifetime and reducing of maintenance costs
  - ▲ Easy installation and removal of the sensor holder
  - ▲ Suitable for liquid-filled sensors
  - ▲ PVDF, protection cage made of Alloy C22
  - ▲ Immersion length 1000 – 2500 mm
  - ▲ Minimum size DN100 / 4"
  - ▲ Up to 6 bar and 95°C
  - ▲ Can be fully automated with pneumatic or electro-pneumatic control units (e.g. CHEMtrol 450 or CHEMtrol 460)



# Retractable holders - *automatic*

## CHEMtrac 810

Retractable holder made of **stainless steel** for installation of Ø12 mm sensors on tanks or pipelines

- Application:**
- ▲ For all kind of Ø12/225 mm (gel-filled) or Ø12/280 mm (liquid-filled) sensors with thread PG 13.5 (e.g. pH- and REDOX, conductivity and temperature and turbidity sensors)
  - ▲ Chemical production
  - ▲ Water and wastewater treatment
  - ▲ Rough processes
  - ▲ Where an automated sensor cleaning and/or calibration is necessary

- Benefits:**
- ▲ Robust design, integrated scraper
  - ▲ Extension of sensor-lifetime and reducing of maintenance costs
  - ▲ Automatic safety lock while sensor is being removed
  - ▲ Plug-and-play installation through colour and size coded connection system
  - ▲ Integrated limit switches
  - ▲ Stainless steel AISI 316L / 1.4404 or Hastelloy
  - ▲ Immersion length up to 107 mm
  - ▲ Wide variety of process connections and sealing materials
  - ▲ Up to 16 bar and 140°C
  - ▲ Can be fully automated with pneumatic or electro-pneumatic control units (e.g. CHEMtrol 450 or CHEMtrol 460)
  - ▲ Maintenance free drive unit



# Retractable holders - *automatic*

## CHEMtrac 811

Retractable holder made of **stainless steel** for installation of Ø12 mm sensors on tanks or pipelines with an **extended immersion length up to 207 mm**

- Application:**
- ▲ For all kind of Ø12/225 mm (gel-filled) or Ø12/280 mm (liquid-filled) sensors with thread PG 13.5 (e.g. pH- and REDOX, conductivity and temperature and turbidity sensors)
  - ▲ Chemical production
  - ▲ Water and wastewater treatment
  - ▲ Rough processes
  - ▲ Where an automated sensor cleaning and/or calibration is necessary

- Benefits:**
- ▲ Robust design, integrated scraper
  - ▲ Extension of sensor-lifetime and reducing of maintenance costs
  - ▲ Automatic safety lock while sensor is being removed
  - ▲ Plug-and-play installation through colour and size coded connection system
  - ▲ Integrated limit switches
  - ▲ Stainless steel AISI 316L / 1.4404 or Hastelloy
  - ▲ Immersion length up to 207 mm
  - ▲ Wide variety of process connections and sealing materials
  - ▲ Up to 16 bar and 140°C
  - ▲ Can be fully automated with pneumatic or electro-pneumatic control units (e.g. CHEMtrol 450 or CHEMtrol 460)
  - ▲ Maintenance free drive unit



# Retractable holders - *automatic*

## CHEMtrac 820

Retractable holder made of **plastics** for installation of Ø12 mm sensors on tanks or pipelines.

- Application:**
- ▲ For all kind of Ø12/225 mm (gel-filled) or Ø12/280 mm (liquid-filled) sensors with thread PG 13.5 (e.g. pH- and REDOX, conductivity and temperature and turbidity sensors)
  - ▲ Chemical production
  - ▲ Water and wastewater treatment
  - ▲ Rough processes
  - ▲ Where an automated sensor cleaning and/or calibration is necessary

- Benefits:**
- ▲ Robust design, integrated scraper
  - ▲ Extension of sensor-lifetime and reducing of maintenance costs
  - ▲ Automatic safety lock while sensor is being removed
  - ▲ Plug-and-play installation through colour and size coded connection system
  - ▲ Integrated limit switches
  - ▲ Available in PP, PVDF or PEEK
  - ▲ Protection cage (made of hastelloy for PVDF and PEEK)
  - ▲ Immersion length up to 94 mm
  - ▲ Wide variety of process connections and sealing materials
  - ▲ Up to 10 bar and 140°C
  - ▲ Can be fully automated with pneumatic or electro-pneumatic control units (e.g. CHEMtrol 450 or CHEMtrol 460)
  - ▲ Maintenance free drive unit

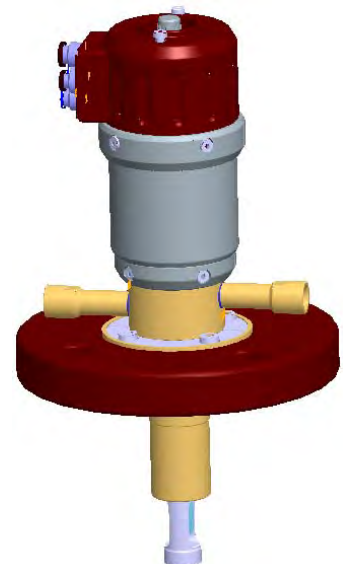

# Retractable holders - *automatic*

## CHEMtrac 821

Retractable holder made of **plastics** for installation of Ø12mm sensors on tanks or pipelines with an **extended immersion length up to 194 mm**.

- Application:**
- ▲ For all kind of Ø12/325 mm (gel-filled) or Ø12/380 mm (liquid-filled) sensors with thread PG 13.5 (e.g. pH- and REDOX, conductivity and temperature and turbidity sensors)
  - ▲ Chemical production
  - ▲ Water and wastewater treatment
  - ▲ Rough processes
  - ▲ Where an automated sensor cleaning and/or calibration is necessary

- Benefits:**
- ▲ Robust design, integrated scraper
  - ▲ Extension of sensor-lifetime and reducing of maintenance costs
  - ▲ Automatic safety lock while sensor is being removed
  - ▲ Plug-and-play installation through colour and size coded connection system
  - ▲ Integrated limit switches
  - ▲ Available in PVDF or PEEK
  - ▲ Protection cage made of hastelloy
  - ▲ Immersion length up to 194 mm
  - ▲ Wide variety of process connections and sealing materials
  - ▲ Up to 10 bar and 140°C
  - ▲ Can be fully automated with pneumatic or electro-pneumatic control units (e.g. CHEMtrol 450 or CHEMtrol 460)
  - ▲ Maintenance free drive unit

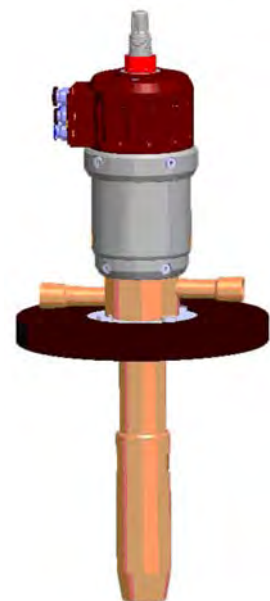



# Retractable holders - *automatic*

## CHEMtrac 830 – hygienic installation

Retractable holder made of stainless steel for **hygienic installation** of Ø12 mm sensors on **tanks or pipelines**.

- Application:**
- ▲ For all kind of Ø12/325 mm (gel-filled) or Ø12/380 mm (liquid-filled) sensors with thread PG 13.5 (e.g. pH- and REDOX, conductivity and temperature and turbidity sensors)
  - ▲ Chemical production
  - ▲ Water and wastewater treatment
  - ▲ Rough processes
  - ▲ Where an automated sensor cleaning and/or calibration is necessary

- Benefits:**
- ▲ Hygienic design, EHEDG/3A–approved process connections
  - ▲ Extension of sensor-lifetime and reducing of maintenance costs
  - ▲ Automatic safety lock while sensor is being removed
  - ▲ Plug-and-play installation through colour and size coded connection system
  - ▲ AISI 316L/1.4404 surface finish Ra<0.8 electropolished
  - ▲ Protection cage, hastelloy
  - ▲ Wide variety of process connections and sealing materials
  - ▲ Up to 10 bar and 140°C
  - ▲ Can be fully automated with pneumatic or electro-pneumatic control units (e.g. CHEMtrol 450 or CHEMtrol 460)
  - ▲ Maintenance free drive unit



# Retractable holders - *manual*

## CHEMtrac 810 M – stainless steel

Manual retractable holder made of **stainless steel** for installation of Ø12 mm sensors on tanks or pipelines **with unique rotary drive**.

- Application:**
- ▲ For all kind of Ø12/225 mm (gel-filled) or Ø12/280 mm (liquid-filled) sensors with thread PG 13.5 (e.g. pH- and REDOX, conductivity and temperature and turbidity sensors)
  - ▲ Chemical production
  - ▲ Water and wastewater treatment
  - ▲ Rough processes
  - ▲ Where an automated sensor cleaning and/or calibration is necessary

- Benefits:**
- ▲ Robust design, integrated scraper
  - ▲ Extension of sensor-lifetime and reducing of maintenance costs
  - ▲ Stainless steel AISI 316L/1.4404 or hastelloy
  - ▲ Immersion length up to 107 mm
  - ▲ Protection cage, hastelloy
  - ▲ Wide variety of process connections and sealing materials
  - ▲ Safe locking system
  - ▲ Indication of measurement and service position
  - ▲ No change of position possible, if no sensor is connected
  - ▲ Manual handling even against 12 bar due to unique rotary drive
  - ▲ Pneumatic drive retrofit



# Retractable holders - *manual*

## CHEMtrac 820 M – plastics

Manual retractable holder made **of plastics** for installation of Ø12 mm sensors on tanks or pipelines with **unique rotary drive**.

- Application:**
- ▲ For all kind of Ø12/225 mm (gel-filled) or Ø12/280 mm (liquid-filled) sensors with thread PG13.5 (e.g. pH- and REDOX, conductivity and temperature and turbidity sensors)
  - ▲ Chemical production
  - ▲ Water treatment
  - ▲ Rough processes
  - ▲ Where an automated sensor cleaning and/or calibration is necessary

- Benefits:**
- ▲ Robust design, integrated scraper
  - ▲ Extension of sensor-lifetime and reducing of maintenance costs
  - ▲ Available in PP, PVDF and PEEK
  - ▲ Immersion length up to 94 mm
  - ▲ Wide variety of process connections and sealing materials
  - ▲ Maintenance free drive unit
  - ▲ Safe locking system
  - ▲ Indication of measurement and service position
  - ▲ No change of position possible, if no sensor is connected
  - ▲ Manual handling even against 12 bar due to unique rotary drive
  - ▲ Pneumatic drive retrofit



# Retractable holders - *manual*

## CHEMtrac 821 M – plastics, extended immersion

Manual retractable holder made **of plastics** for installation of Ø12 mm sensors on tanks or pipelines with an extended **immersion length up to 194 mm** with **unique rotary drive**.

- Application:**
- ▲ For all kind of Ø12/325 mm (gel-filled) or Ø12/380 mm (liquid-filled) sensors with thread PG13.5 (e.g. pH- and REDOX, conductivity and temperature and turbidity sensors)
  - ▲ Chemical production
  - ▲ Water treatment
  - ▲ Rough processes
  - ▲ Where an automated sensor cleaning and/or calibration is necessary

- Benefits:**
- ▲ Robust design, integrated scraper
  - ▲ Extension of sensor-lifetime and reducing of maintenance costs
  - ▲ PVDF and PEEK
  - ▲ Protection cage, hastelloy
  - ▲ Immersion length up to 194 mm
  - ▲ Wide variety of process connections and sealing materials
  - ▲ Maintenance free drive unit
  - ▲ Safe locking system
  - ▲ Indication of measurement and service position
  - ▲ No change of position possible, if no sensor is connected
  - ▲ Manual handling even against 12 bar due to unique rotary drive
  - ▲ Pneumatic drive retrofit



# Retractable holders - *manual*

## CHEMtrac 830 M – hygienic installation

Manual retractable holder made of stainless steel for **hygienic installation** of Ø12 mm sensors on tanks or pipelines with **unique rotary drive**.

- Application:**
- ▲ For all kind of Ø12/225 mm (gel-filled) or Ø12/280 mm (liquid-filled) sensors with thread PG13.5 (e.g. pH- and REDOX, conductivity and temperature and turbidity sensors)
  - ▲ Foodproduction
  - ▲ Pharmaceutical production
  - ▲ Where a sensor removal under process terms is necessary
- Benefits:**
- ▲ Hygienic design, EHEDG/3A approved process connections
  - ▲ Extension of sensor-lifetime and reducing of maintenance costs
  - ▲ AISI 316L/1.4404 surface finish Ra<0.8 electropolished
  - ▲ Wide variety of process connections and sealing materials
  - ▲ Maintenance free drive unit
  - ▲ Safe locking system
  - ▲ Indication of measurement and service position
  - ▲ No change of position possible, if no sensor is connected
  - ▲ Manual handling even against 12 bar due to unique rotary drive
  - ▲ Pneumatic drive retrofit



# Manual control units

## CHEMtrol 450

**Manual control unit** with cleaning function and integrated connecting hose for retractable holders.

**Application:**       **Everywhere a pneumatic retractable holder shall be controlled manually**

**Benefits:**

-  **Robust design**
-  **Integrated connecting hose for plug-and-play operation**
-  **Up to 2 different cleaning solutions can be controlled**
-  **Detection of holder position**
-  **Driven by air at 6 bar**
-  **No electrical installation necessary**



# Automatic control units

## CHEMtrol 460

**Electro pneumatical control unit** with individual programmable cleaning functions and integrated connecting hose for retractable holders

**Application:**      ▲ **Everywhere a pneumatic retractable holder shall be controlled manually**

**Benefits:**

- ▲ **Robust design**
- ▲ **Integrated connecting hose for plug-and-play operation**
- ▲ **Up to 2 different cleaning solutions can be controlled**
- ▲ **Detection of holder position**
- ▲ **Driven by air at 6 bar**
- ▲ **No electrical installation necessary**





# Flow vessels

## CHEMflow 710

The flow vessel CHEMflow 710 is made of **stainless steel** and is a suitable accessory for the pneumatical **retractable holder** CHEMtrac 810 or the **static sensor holder** CHEMfit 310. These combinations ensure the optimal position of a measuring sensor directly in the flow stream.

- Application:**
- ▲ Inline measurement
  - ▲ Bypass measuring points
  - ▲ Chemical production
  - ▲ Water treatment

- Benefits:**
- ▲ Flexible design
  - ▲ DN25/1" or DN50/2"
  - ▲ 90° or 180° flow direction
  - ▲ Best sensor position
  - ▲ Stainless steel AISI 316Ti/1.4571 or ETFE-lined
  - ▲ Wide variety of process connections
  - ▲ Up to 16 bar and 140°C

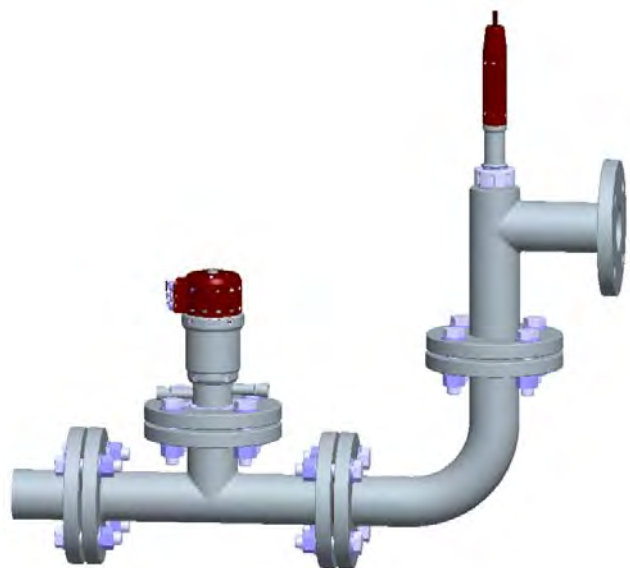

# Flow vessels

## CHEMflow 720

The flow vessel CHEMflow 720 is **made of plastic** and is a suitable accessory **for the pneumatical retractable holder CHEMtrac 820**. This combination ensures the optimal position of a measuring sensor directly in the flow stream.

- Application:**
- ▲ Inline measurement
  - ▲ Bypass measuring points
  - ▲ Chemical production
  - ▲ Water treatment

- Benefits:**
- ▲ Flexible design
  - ▲ DN25/1" or DN50/2"
  - ▲ 90° or 180° flow direction
  - ▲ Best sensor position
  - ▲ PVDF
  - ▲ Wide variety of process connections
  - ▲ Up to 6 bar and 120°C

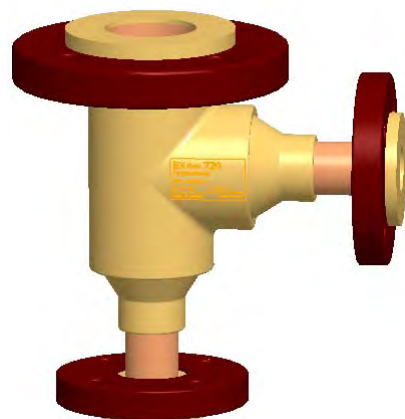
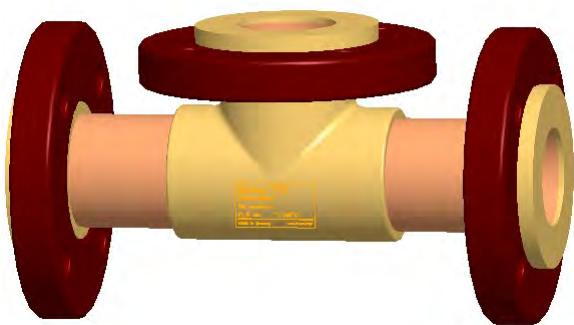

## SI Analytics



По вопросам продаж и поддержки обращайтесь:

Архангельск (8182)63-90-72  
Астана +7(7172)727-132  
Белгород (4722)40-23-64  
Брянск (4832)59-03-52  
Владивосток (423)249-28-31  
Волгоград (844)278-03-48  
Вологда (8172)26-41-59  
Воронеж (473)204-51-73  
Екатеринбург (343)384-55-89  
Иваново (4932)77-34-06  
Ижевск (3412)26-03-58  
Казань (843)206-01-48

Калининград (4012)72-03-81  
Калуга (4842)92-23-67  
Кемерово (3842)65-04-62  
Киров (8332)68-02-04  
Краснодар (861)203-40-90  
Красноярск (391)204-63-61  
Курск (4712)77-13-04  
Липецк (4742)52-20-81  
Магнитогорск (3519)55-03-13  
Москва (495)268-04-70  
Мурманск (8152)59-64-93  
Набережные Челны (8552)20-53-41

Нижний Новгород (831)429-08-12  
Новокузнецк (3843)20-46-81  
Новосибирск (383)227-86-73  
Орел (4862)44-53-42  
Оренбург (3532)37-68-04  
Пенза (8412)22-31-16  
Пермь (342)205-81-47  
Ростов-на-Дону (863)308-18-15  
Рязань (4912)46-61-64  
Самара (846)206-03-16  
Санкт-Петербург (812)309-46-40  
Саратов (845)249-38-78

Смоленск (4812)29-41-54  
Сочи (862)225-72-31  
Ставрополь (8652)20-65-13  
Тверь (4822)63-31-35  
Томск (3822)98-41-53  
Тула (4872)74-02-29  
Тюмень (3452)66-21-18  
Ульяновск (8422)24-23-59  
Уфа (347)229-48-12  
Челябинск (351)202-03-61  
Череповец (8202)49-02-64  
Ярославль (4852)69-52-93